

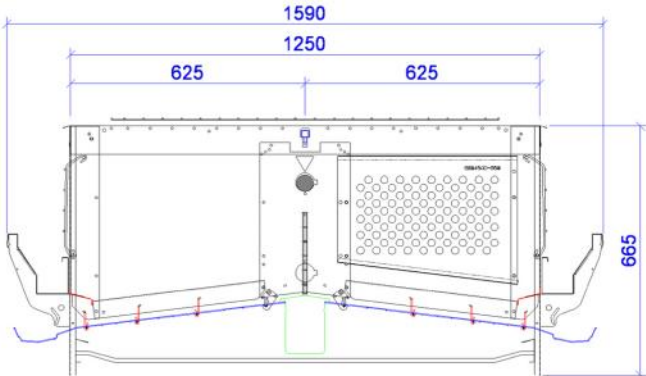

Euro SO 10

- Cage length: 1,205 mtr.
- Cage depth: 62,5 cm
- Cage heights 3 tiers: 2,23 mtr.
- Row width: 1,59 mtr.
- Tier distance: 665 mm
- Bird places: 10 birds per cage / 753 cm² per bird
- Nest position: cage back
- Feeding: chain
- Perches: 15 cm / bird
- Scratching Area: on top of the nest
- Extras: Automatic filling

technical data			length of compartment: 1205 mm	
type	A overall row width [mm]	B depth of cage [mm]	type 625 - 10	
			cage area [cm ²]	10 birds length of trough/bird 12cm space / bird [cm ²]
625	1590			
625 KL	1590	625	7531	753
625 GL	1690			

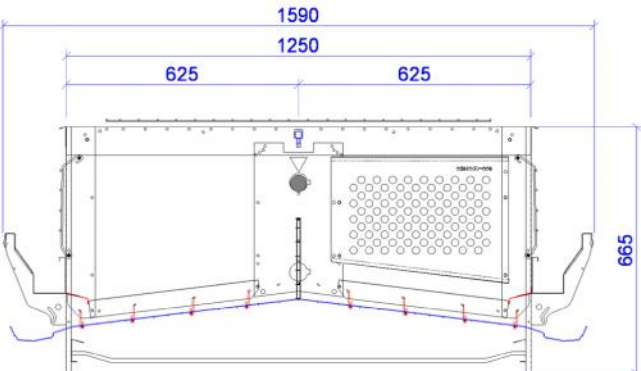
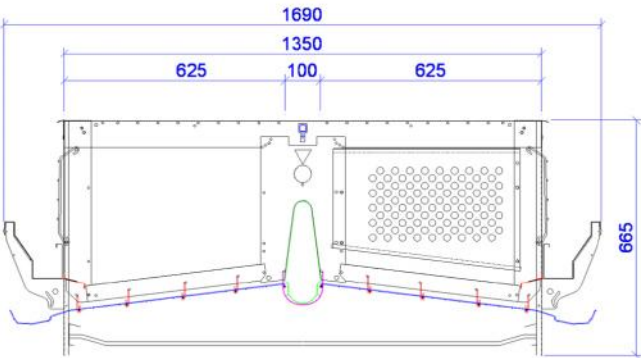

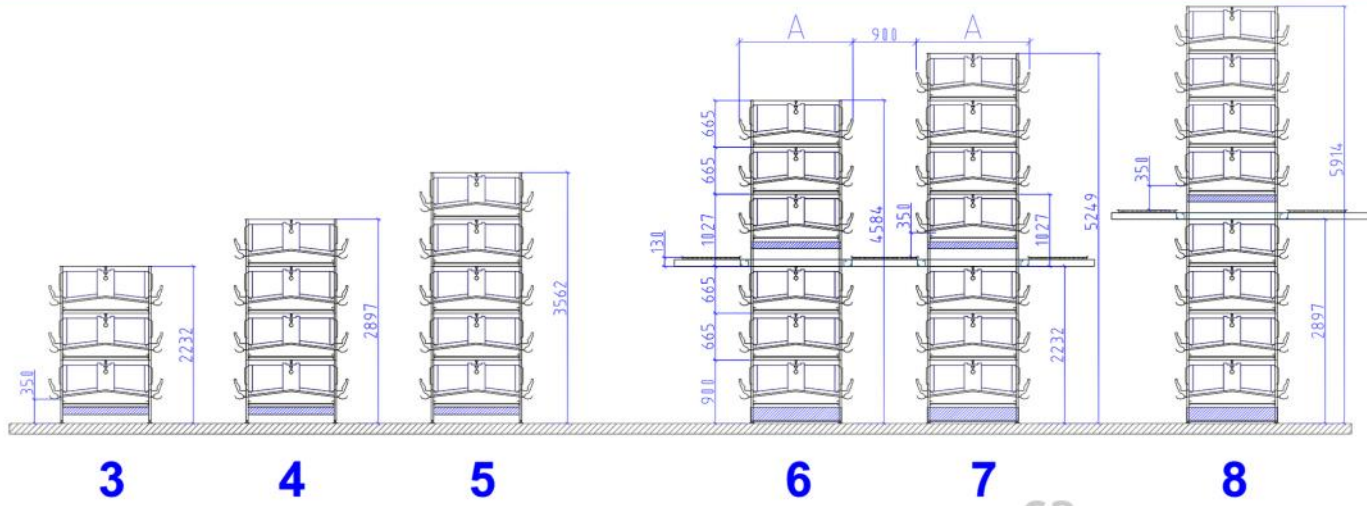

- GB**
1. Egg collection – liftsystem elevator
 - 1* Elevator with simultaneous transfer
 2. Feeding System
 3. Watering System
 4. Air channel
 5. Dust bath supply
 6. Reverse station
 7. Reverse station feed chain
 8. drive station without manifold for airmixer
 - 8* drive station with manifold for airmixer
 9. Cross conveyor belt

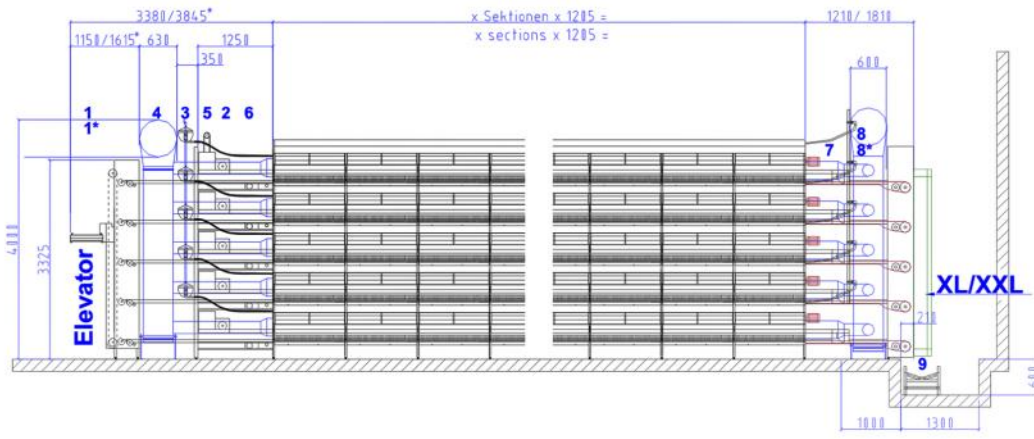

- FRA**
1. Lift élévateur
 - 1* Elévateur transfert simultané
 2. Alimentation à chaîne
 3. Abreuvement
 4. Gaine à séchage
 5. Alimentation bac à sable
 6. Retour tapis à fiente
 7. Retour chaîne d'alimentation
 8. entrainement tapis sans distributeur pour mélangeur
 - 8* entrainement tapis avec distributeur pour mélangeur
 9. Convoyeur transversal

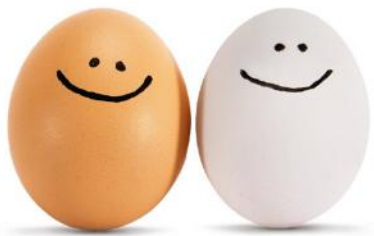

Made in Germany.

Euro SO 24

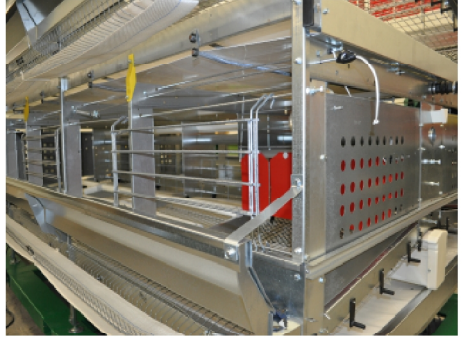

Euro SO 24

Compartment length:	241 cm
Compartment depth:	690 mm
Height 3 tiers:	2,23 m
Row width:	172 cm
Tier height:	665 mm
Birds per compartment:	24
Surface per bird:	767 cm ²
Nest position:	at the back
Perch per bird:	15 cm
Scratching area:	on nest
Extras:	Automatic filling Automatic doors for scratching area

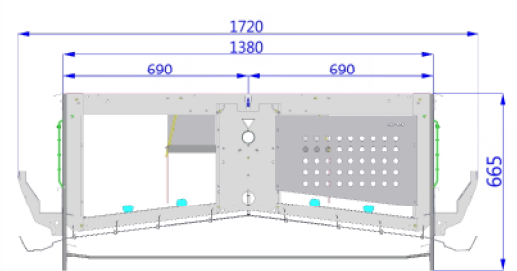
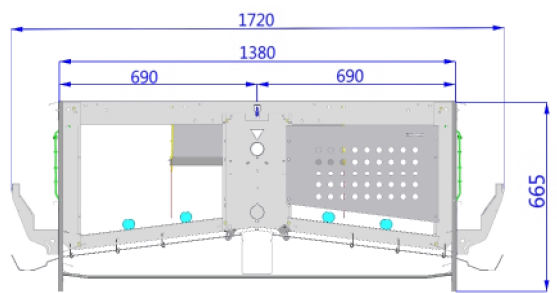
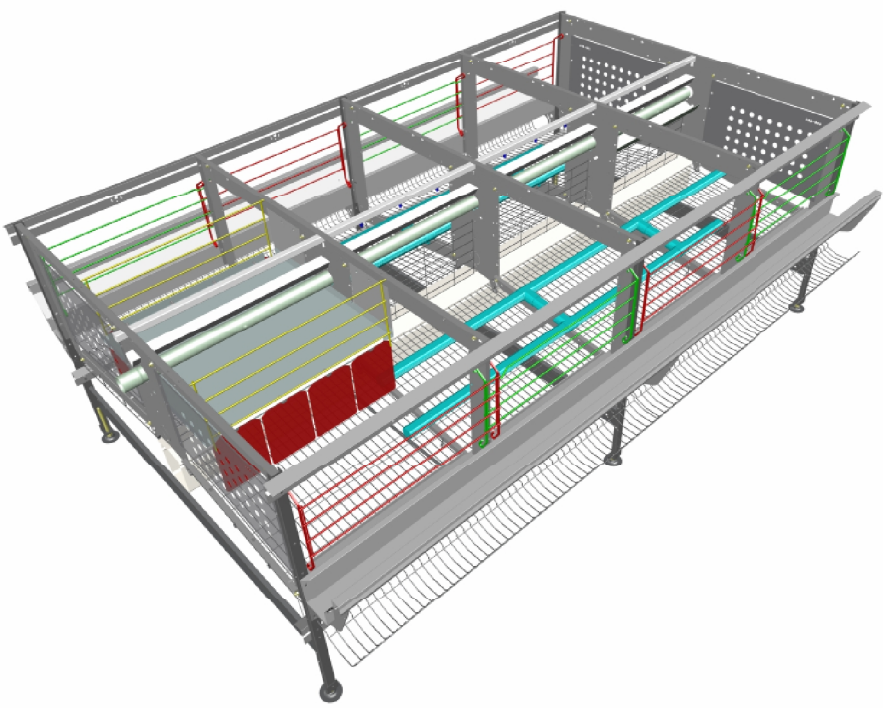

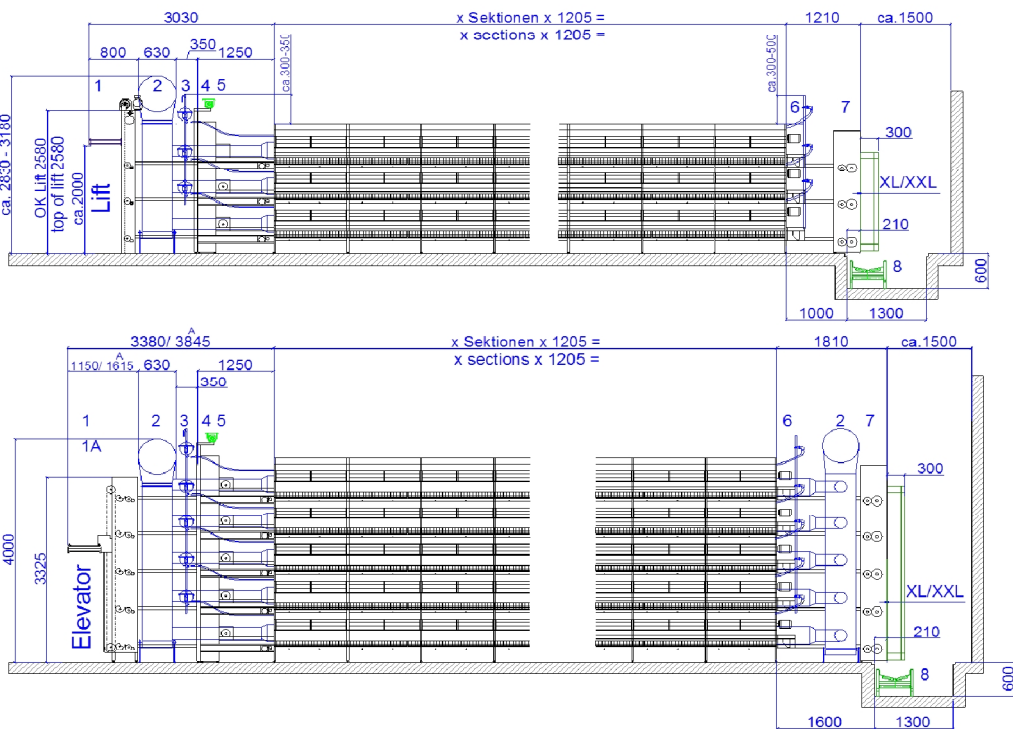
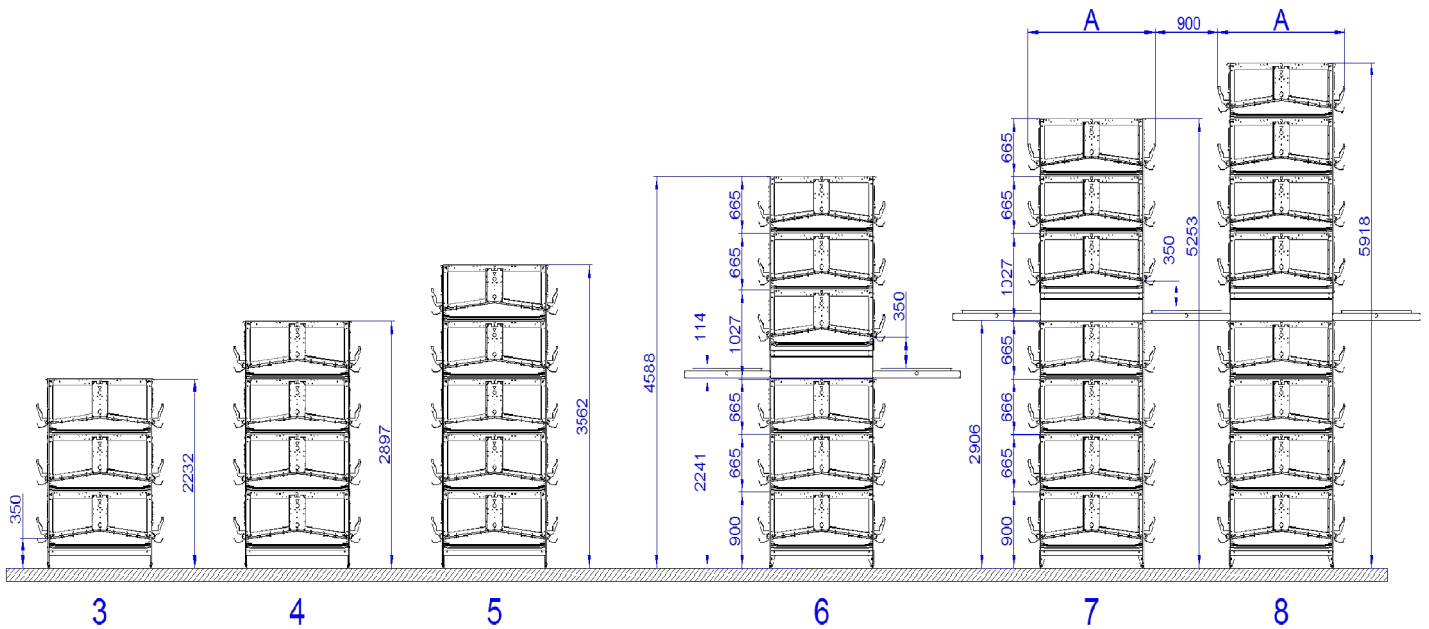

1. Egg collection - liftsystem elevator
- 1A. Elevator with simultaneous transfer
2. Air channel
3. Watering System
4. Feed chain drive
5. Reverse station
6. Reverse station feed chain
7. Drive Station
8. Cross conveyor belt

1. Lift élévateur
- 1A. Elévateur transfert simultané
2. Gaine à séchage
3. Abreuvement
4. Entraînement chaîne
5. Retour tapis à fiente
6. Retour chaîne d'alimentation
7. Entraînement tapis à fiente
8. Convoyeur transversal

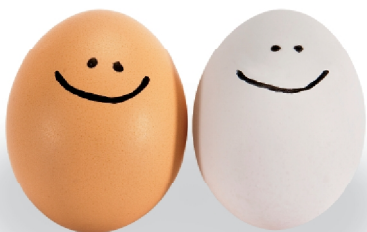

Made in Germany.

Hellmann Poultry GmbH & Co. KG · Kopernikusstr. 6-10 · 49377 Vechta
 P.O. BOX 1232 · 49361 Vechta · Germany · Phone +49 4441 9259-0
 Fax +49 4441 9259-50 · www.hellmannpoultry.de

Euro SO 33



Euro SO 33

Compartment length:	241 cm
Compartment depth:	925 mm
Row width:	2,190 m
Tier height:	735 mm
Birds per compartment:	33
Surface per bird:	753 cm ²
Perch per bird:	15 cm
Scratching area:	on nest
Extras:	Automatic filling Automatic doors for scratching area

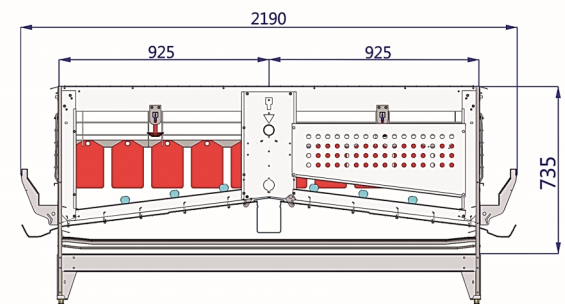
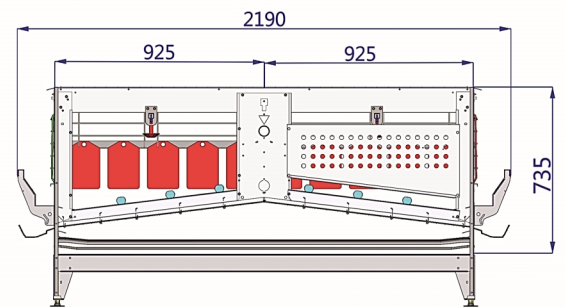
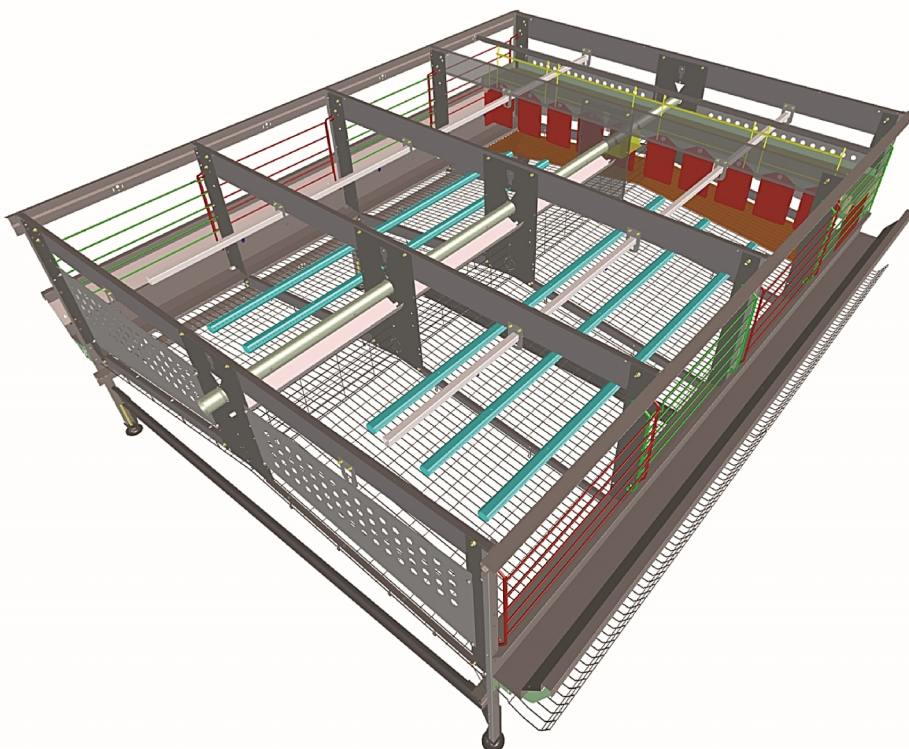

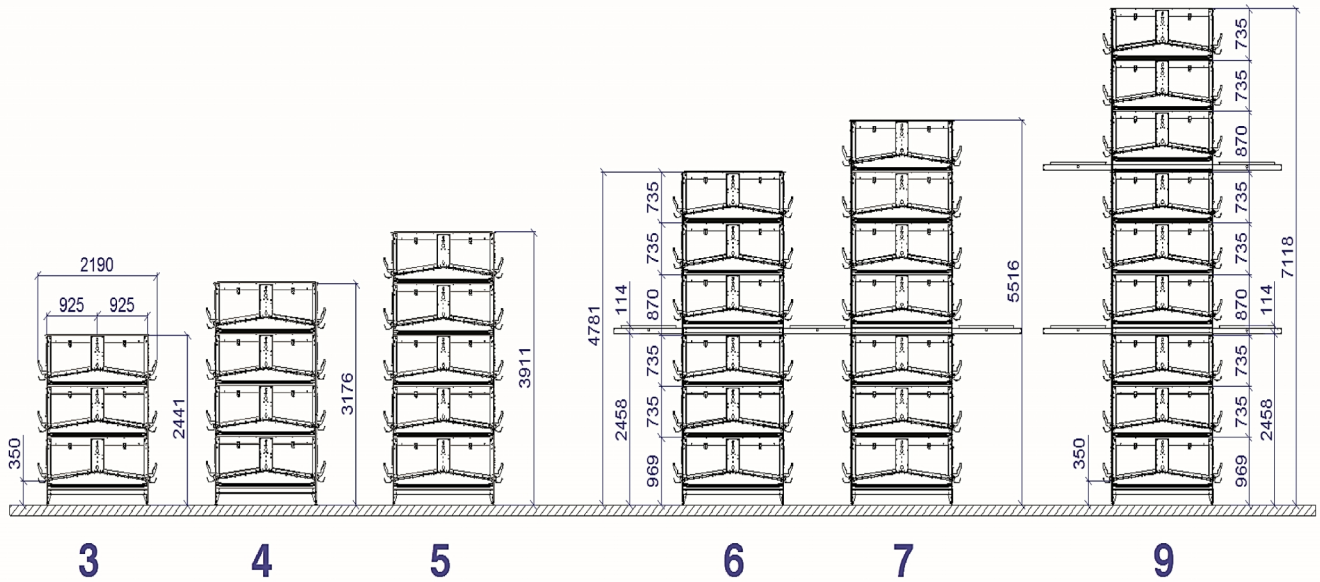

- 1. Egg collection – liftsystem elevator
- 1A. Elevator with simultaneous transfer
- 2. Air channel
- 3. Watering System
- 4. Feed chain drive
- 5. Reverse station
- 6. Reverse station feed chain
- 7. Drive Station
- 8. Cross conveyor belt

- 1. Lift élévateur
- 1A. Elévateur transfert simultané
- 2. Gaine à séchage
- 3. Abreuvement
- 4. Entraînement chaîne
- 5. Retour tapis à fiente
- 6. Retour chaîne d'alimentation
- 7. Entraînement tapis à fiente
- 8. Convoyeur transversal

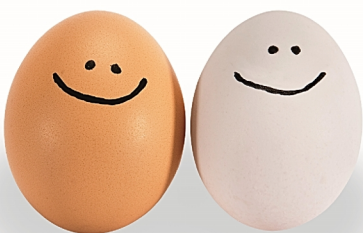
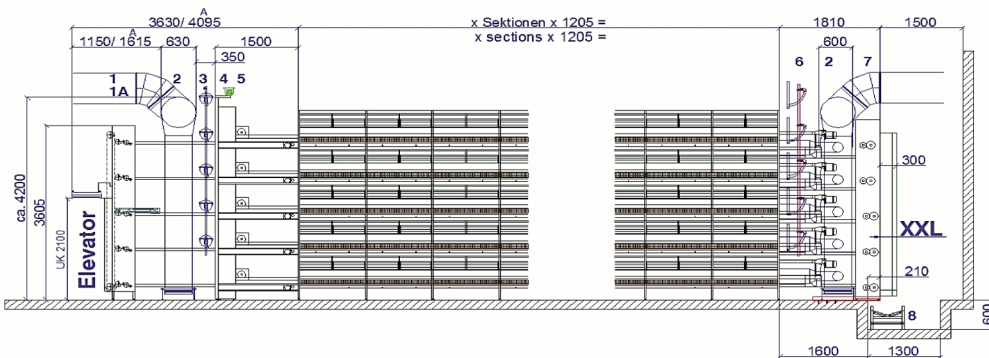
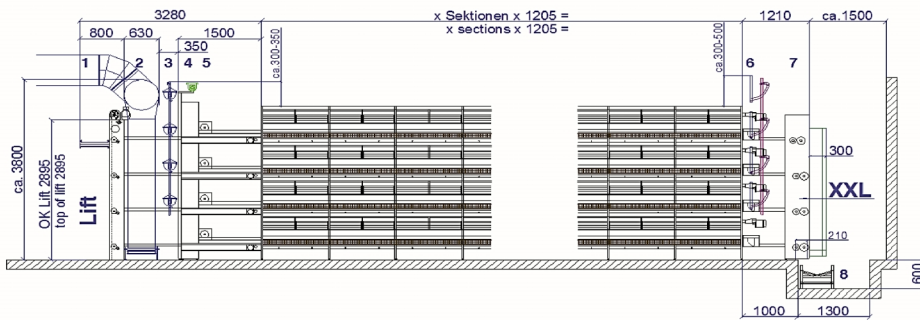

Made in Germany.

Hellmann Poultry GmbH & Co. KG · Kopernikusstr. 6–10 · 49377 Vechta
 P.O. BOX 1232 · 49361 Vechta · Germany · Phone +49 4441 9259-0
 Fax +49 4441 9259-50 · www.hellmannpoultry.de