

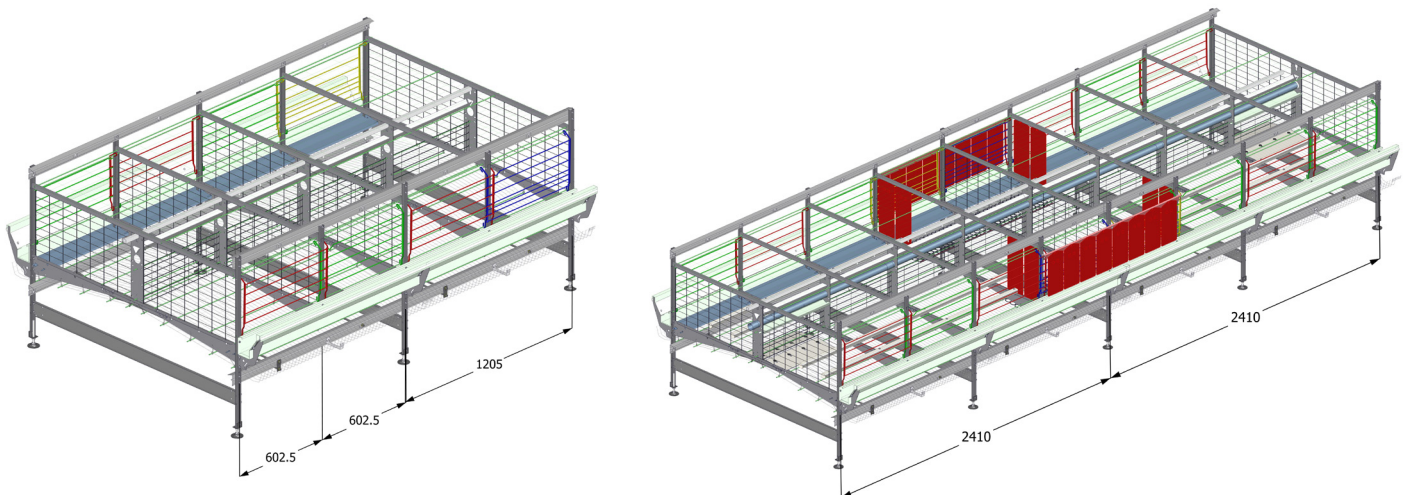

## Enrichable 2.0

### *The versatile system for sustainable egg production*

The enrichable cage system developed by Hellmann Poultry has all the advantages of our traditional laying cage, including its versatility with regard to different climate zones, but it is already prepared for future enrichment with nests, perches and scratching areas. This way it can simply be upgraded in line with local legal requirements and welfare guidelines. The individual compartments are higher and provide the hens with more space. And in the same manner as the traditional cages, the enrichable version can be equipped with additional features such as the Egg Saver system, stepping rails, different types of inspection carts, manure drying etc. This allows you to increase the well-being of your hens without losing any of the productivity of traditional cage production systems.



**Has all the advantages of our conventional tropical cages and more**

**Ready for future enrichment with nests, perches and scratching pads**

**Individual compartments are higher and provide more space for the hens**

**Strong and durable design**

**Profitable egg production with healthy hens and excellent egg quality**

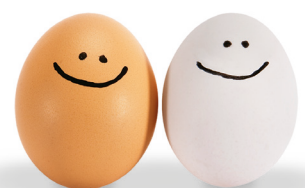

# Enrichable cages

*Healthy hens and excellent egg quality*

**ENHANCED  
VERSION**



**Compartment width: 602.5 mm / 1205 mm**

**Compartment width (enriched): 2410 mm**

**Compartment depth: 750 mm**

**Tier height: 665 mm**

**Row width: 1840 mm**

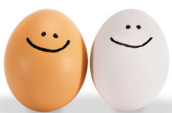
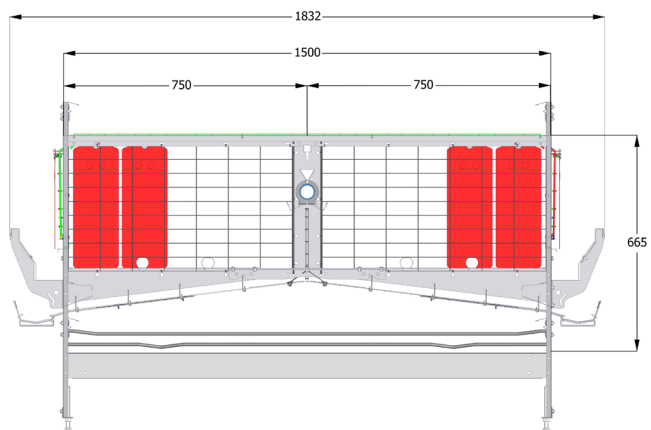
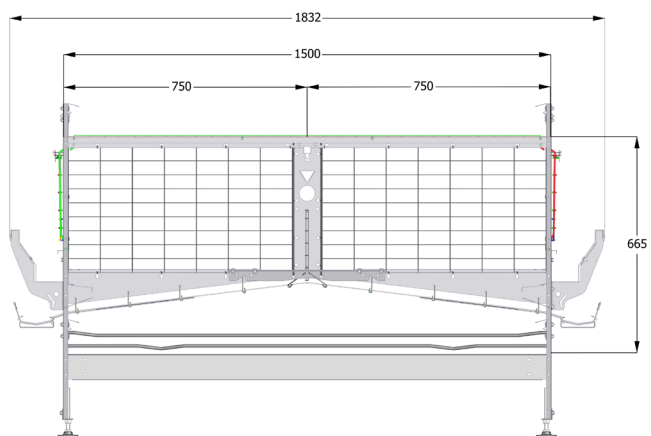

**Hellmann Poultry GmbH & Co. KG**  
Alter Flugplatz 50 · D-49377 Vechta · Germany  
P.O. BOX 1232 · D-49361 Vechta · Germany  
Phone +49 4441 9259-0 · info@hellmannpoultry.de