

## Enriched colony cages

*High laying performance and  
optimal animal welfare*





## Enriched colony cages

### *High laying performance and optimal animal welfare*

As the regulations with regard to animal welfare and possible enrichments vary, there are different types of enriched cages available. The type of enriched cage should be selected based on the regional applicable regulations as the layout and characteristics of the installed enrichments play a decisive role for the health of the hens, the cleanliness of the cage and the egg quality.



### **The enriched colony cages type NF**

have the laying nest placed at the front and give the eggs an extremely short way to the safety of the egg channel. Needless to say that these models comply with all regulations and offer birds the so called 5 freedoms. This model comes with solid or wire partitions, with or without manure drying and several options or features that can be chosen or left out, depending on local established interpretations of regulations. The height of the cages also reduces the risk of coccidiosis, as there is less contact of hens with the manure belt of the superior tier.

## ADVANTAGES

- Nests at the front for excellent egg quality thanks to the short egg travel distance
- No. of birds per compartment depends on cage depth
- Scratching areas and dust bathing increase the physical well-being of the hens
- Backwall between the compartments for easy access to the birds
- Choice between solid, perforated or wire partitions

## ENRICHED COLONY CAGE

### NF20

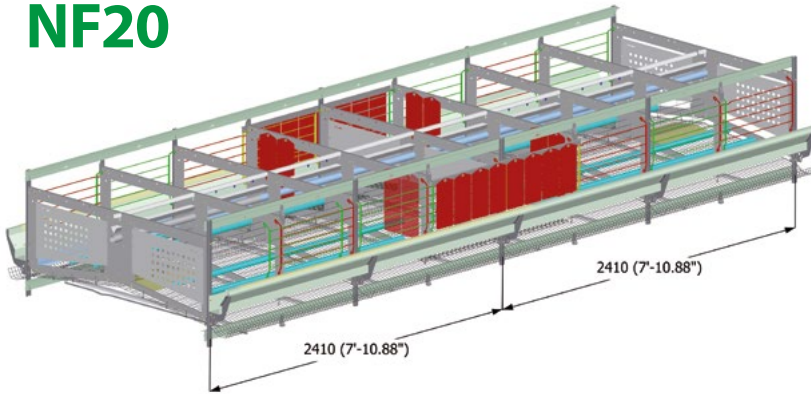

<b>Compartment size:</b>	64 x 241 cm	25.2" x 7.9'
<b>Compartment Length:</b>	241 cm	7.9'
<b>Depth:</b>	64 cm	25.2"
<b>Height 3 tiers:</b>	223 cm	7.3'
<b>Height 4 tiers:</b>	300 cm	9.8'
<b>Height 6 tiers w/tween deck:</b>	471 cm	15.4'
<b>Row width:</b>	162 cm	5.3'
<b>Tier height:</b>	66.5 cm	26.2"
<b>Birds per compartment:</b>	20	20
<b>Total space per bird:</b>	771 cm <sup>2</sup>	119.5 sq in
<b>Trough space per bird:</b>	9 cm	3.5"
<b>Perch per bird:</b>	15 cm	5.91"
<b>Birds per nipple:</b>	7	7

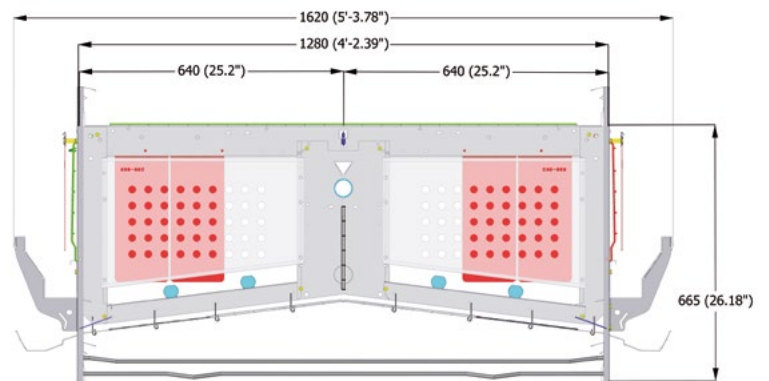

## ENRICHED COLONY CAGE

### NF22

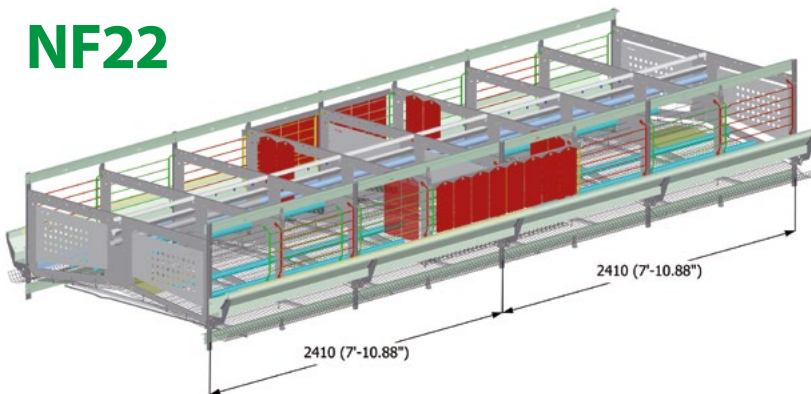

<b>Compartment size:</b>	69 x 241 cm	27.17" x 7.9'
<b>Compartment Length:</b>	241 cm	7.9'
<b>Depth:</b>	69 cm	27.17"
<b>Height 3 tiers:</b>	223 cm	7.3'
<b>Height 4 tiers:</b>	300 cm	9.8'
<b>Height 6 tiers w/tween deck:</b>	471 cm	15.4'
<b>Row width:</b>	172 cm	5.64'
<b>Tier height:</b>	66.5 cm	26.2"
<b>Birds per compartment:</b>	22	22
<b>Total space per bird:</b>	755 cm <sup>2</sup>	117.03 sq in
<b>Trough space per bird:</b>	8.2 cm	3.23"
<b>Perch:</b>	15 cm	5.91"
<b>Birds per nipple:</b>	7	7

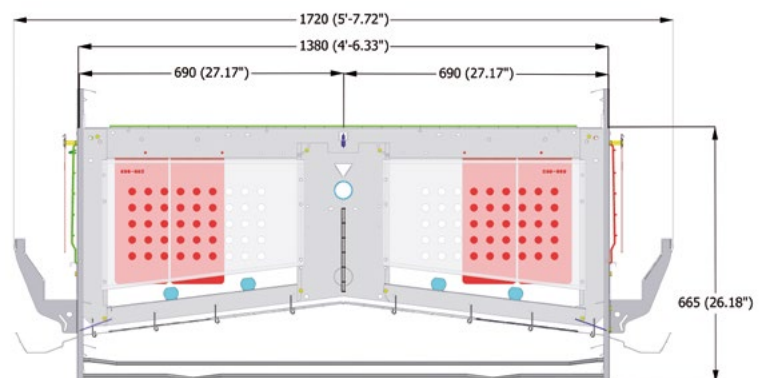

## ENRICHED COLONY CAGE

### NF24

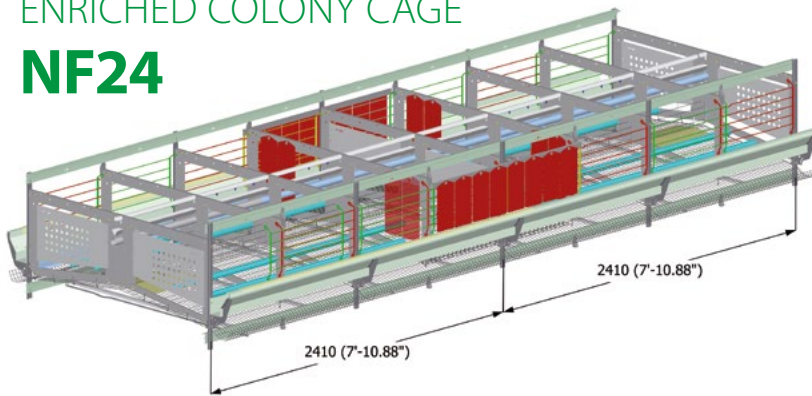

<b>Compartment size:</b>	75 x 241 cm	29.53" x 7.9'
<b>Compartment Length:</b>	241 cm	7.9'
<b>Depth:</b>	75 cm	29.53"
<b>Height 3 tiers:</b>	223 cm	7.3'
<b>Height 4 tiers:</b>	300 cm	9.8'
<b>Height 6 tiers w/tween deck:</b>	471 cm	15.4'
<b>Row width:</b>	184 cm	6.04'
<b>Tier height:</b>	66.5 cm	26.2"
<b>Birds per compartment:</b>	24	24
<b>Total space per bird:</b>	765 cm <sup>2</sup>	118.58 sq in
<b>Trough space per bird:</b>	10.2 cm	4.02"
<b>Perch:</b>	15.2 cm	5.98"
<b>Birds per nipple:</b>	8	8

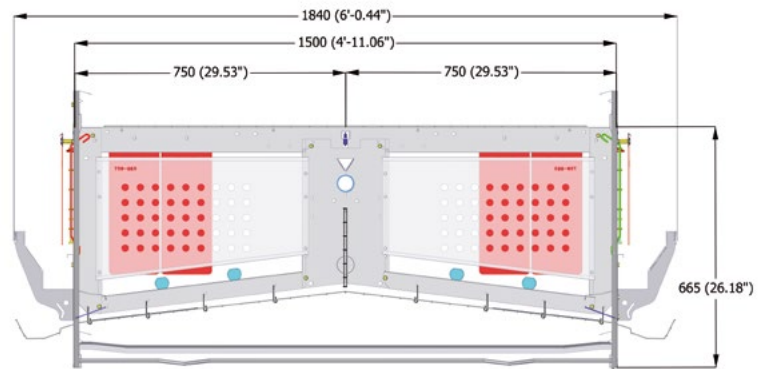
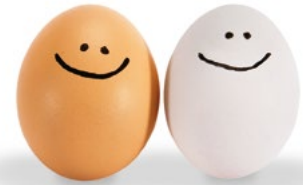

## ENRICHED COLONY CAGE

### NF29

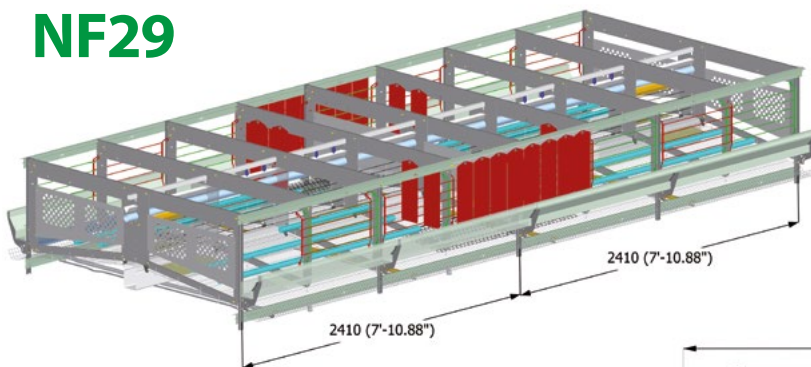

<b>Compartment size:</b>	92.5 x 241 cm	36.42" x 7.9'
<b>Compartment Length:</b>	241 cm	7.9'
<b>Depth:</b>	92.5 cm	36.42"
<b>Height 3 tiers:</b>	244 cm	8.0'
<b>Height 4 tiers:</b>	318 cm	10.4'
<b>Height 6 tiers w/tween deck:</b>	496 cm	16.3'
<b>Row width:</b>	220 cm	7.22'
<b>Tier height:</b>	73.5 cm	28.94"
<b>Birds per compartment:</b>	29	29
<b>Total space per bird:</b>	768 cm <sup>2</sup>	119.04 sq in
<b>Trough space per bird:</b>	8.3 cm	3.27"
<b>Perch:</b>	15 cm	15 cm
<b>Birds per nipple:</b>	7	7

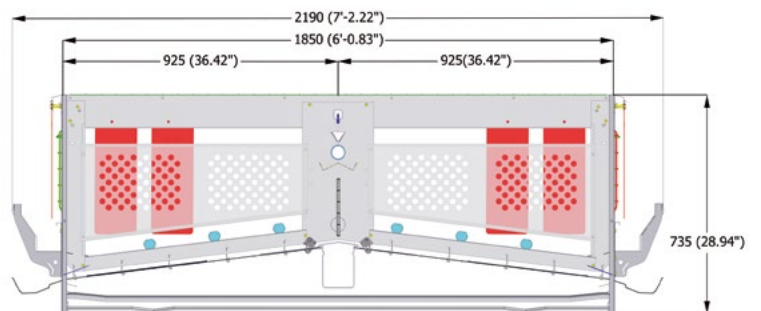

#### Hellmann Poultry GmbH & Co. KG

Alter Flugplatz 50 · D-49377 Vechta · Germany  
 P.O. BOX 1232 · D-49361 Vechta · Germany  
 Phone +49 4441 9259-0 · info@hellmannpoultry.de